



Lexmark CX943adtse

Powerful, large-format addition to your printer fleet



Lexmark CX943adtse

The Lexmark CX943adtse large-format colour multifunction is designed for security, versatility and performance for large workgroups at speeds up to 55 pages per minute*. Loaded with standard features, this model includes a 25 cm touchscreen, single-pass two-sided scanning with ultrasonic multi-feed detection and Optical Character Recognition (OCR).



Productivity is in the box

- ▶ Maximise productivity with workflow solutions like Scan Centre for simple document routing and single-pass two-sided scanning with ultrasonic multi-feed detection for fast and reliable scanning.
- ▶ The Intelligent Storage Drive (ISD) provides solid state storage with activation-ready preloaded add-on solutions.
- ▶ A large, button-free touchscreen helps users intuitively complete every task, from the basic to the complex.

Flexible input and output

- ▶ Print and scan large-format paper sizes slightly larger than SRA3+ (up to 329 x 483 mm).
- ▶ Standard input capacity is 2,180 pages; optional additional trays expand paper input capacity up to 4,180 pages.
- ▶ Several finishing options are available: staple finisher, staple hole punch finisher, booklet finisher or Lexmark's first trifold/Z-fold finisher.

Professional colour for large-format printing

- ▶ Enjoy vibrant colour with standard advanced features like PANTONE® calibration and Lexmark Named Colour

Replacement for consistent branding and professional appearance.

- ▶ Replacement cartridges yield up to 45,000/22,000 black/colour pages**.

Secure by design

- ▶ Lexmark security features help keep your information safe - in the document, on the device, over the network and at all points in between.
- ▶ Always improving security, we now include a standard Trusted Platform Module***, which delivers authentication, system integrity checks, and cryptographic capabilities to create a unique digital system fingerprint.
- ▶ A proximity sensor wakes up the device when someone is nearby and automatically logs off when no one is nearby.

Sustainability matters

- ▶ CX943adtse is designed for the circular economy.
- ▶ Automatic two-sided printing is standard, along with built-in energy-saving modes that help support ratings of EPEAT® Silver and ENERGY STAR® certified.
- ▶ The award-winning Lexmark Cartridge Collection Programme (LCCP) and Lexmark Equipment Collection Programme (LECP) minimise waste and support recycling (availability varies by country).

Power up with IoT

- ▶ Our sophisticated, IoT-enabled printers are loaded with sensors that continuously monitor hundreds of data points.
- ▶ When you connect your device to Lexmark Cloud Services, you can optimise performance and uptime with additional features like predictive service and automatic supplies replenishment.

This is a Class A device according to international electromagnetic emissions standards (i.e. FCC Rules, EN 55022/EN 55032, etc.). Class A products are intended for use in non-residential/non-domestic environments. Use of a Class A product in residential/domestic environments may cause interference to radio communications and require corrective measures.

* Print speeds measured in accordance with ISO/IEC 24734 (ESAT). For more information see: www.lexmark.com/ISOspeeds.

** Average continuous black or continuous composite colour (CMY) declared yield in one-sided (simplex) mode up to this number of pages in accordance with ISO/IEC 19798. Actual yield will vary considerably based upon many factors. See www.lexmark.com/yields for more information.

*** The Trusted Platform Module (TPM) is not available in some countries.

Lexmark CX943adtse

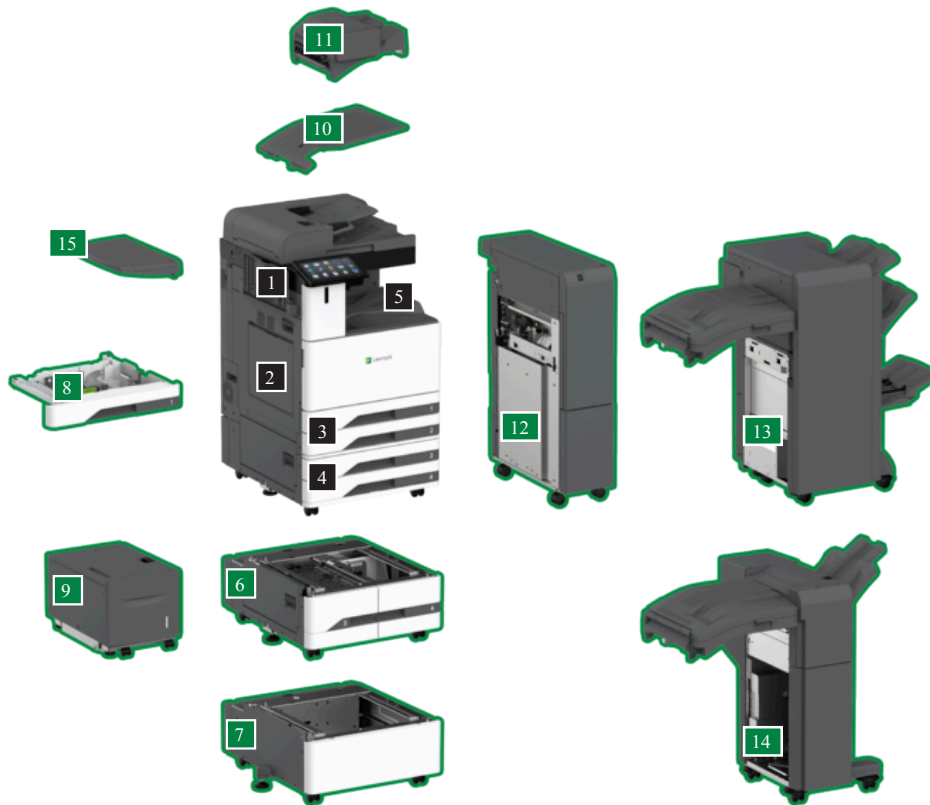

- 1 **Multifunction product with 25 cm touch screen**
1141 x 620 x 754 mm
- 2 **100-Sheet multipurpose feeder**
Dimensions included as part of base model
- 3 **2 x 520-Sheet tray**
Dimensions included as part of base model
- 4 **2 x 520-Sheet tray with casters**
Dimensions included as part of base model
- 5 **400-Sheet output bin**
Dimensions included as part of base model
- 6 **2,000-Sheet Tandem Tray with Casters**
305.2 x 668.5 720 mm
- 7 **Caster Spacer**
305 x 669 x 720 mm
- 8 **Envelope Tray**
89.9 x 619.9 x 565.5 mm
- 9 **2,000-Sheet Tray (sidecar)**
491 x 751 x 526 mm

- 10 **Dual Catch Bin**
125 x 474 x 380 mm
- 11 **Inline Staple Finisher**
238 x 478 x 460.5 mm
- 12 **Tri-Fold/Z-Fold Booklet Finisher**
991 x 232 x 726 mm
- 13 **Booklet Staple (2/3) Hole Punch Finisher**
1056 x 790 x 589 mm
- 14 **Staple (2/3) Hole Punch Finisher**
983 x 962 x 653 mm
- 15 **Work Table**
82 x 303 x 528 mm



| | |
|---|--|
| P/N 32D0373 | Hardware Lexmark CX943adtse |
| P/N 73D0P00 | Supplies Lexmark CS943, CX942, 943, 944, XC9445, 55, 65 Black 165K Photoconductor |
| 73D0Q00 | Lexmark CS943, CX942, 943, 944, XC9445, 55, 65 3-Pack 165K Photoconductor Kit |
| 73D0W00 | Lexmark CS943, CX942, 943, 944, XC9445, 55, 65 35K Waste Container |
| 83D0HCO | Lexmark CX942, 943, 944 Cyan 22K Toner Cartridge |
| 83D0HK0 | Lexmark CX942, 943, 944 Black 45K Toner Cartridge |
| 83D0HM0 | Lexmark CX942, 943, 944 Magenta 22K Toner Cartridge |
| 83D0HY0 | Lexmark CX942, 943, 944 Yellow 22K Toner Cartridge |
| P/N 32D0810 | Paper Handling Caster Spacer |
| 32D0811 | 2 x 520-Sheet Tray with Casters |
| 32D0812 | 2,000-Sheet Tandem Tray with Casters |
| 32D0813 | Envelope Tray |
| 32D0816 | 2,000-Sheet Tray (sidecar) |
| 32D0819 | Dual Catch Bin |
| 32D0820 | Inline Staple Finisher |
| 32D0823 | Staple (2/3) Hole Punch Finisher |
| 32D0824 | Staple (2/4) Hole Punch Finisher |
| 32D0825 | Booklet Staple (2/3) Hole Punch Finisher |
| 32D0826 | Booklet Staple (2/4) Hole Punch Finisher |
| 32D0846 | Tri-Fold/Z-Fold Booklet Finisher |
| P/N 27X0400 | Memory Options 500+ GB Hard Disk |
| P/N 57X0300 57X0301 | Application Solutions Contact Authentication Device Contactless Authentication Device |
| 82S1203 | IPDS Licence |
| 82S1204 | Bar Code Licence |
| P/N 1021294 14F0100 27X0142 | Connectivity USB Cable - 2 Metre RS-232C Serial Interface Card Lexmark MarkNet™ N8230 Fibre Ethernet Print Server |
| 27X6410 | Lexmark MarkNet N8372 802.11 a/b/g/n/ac Wireless Print Server |
| 57X7040 SPD0002 | English Keyboard Kit Surge Protective Device, 220-240V |
| P/N 32D0809 | Furniture CX94x Work Table |

You can install one of the following: the Dual Catch Bin or the Inline Staple Finisher or the Staple Hole Punch Finisher or the Booklet Staple Hole Punch Finisher.
 To install the Tri-Fold/Z-Fold Finisher, you must also install the Booklet Staple Hole Punch Finisher.
 To install the Staple Hole Punch Finisher or Booklet Staple Hole Punch Finisher, you must also install the 2x520-Sheet Tray with Casters, the 2,000-Sheet Tandem Tray with Casters, or the Caster Spacer.
 To install the 2,000-Sheet Tray (sidecar), you must also install the 2x520-Sheet Tray with Casters or the 2,000-Sheet Tandem Tray with Casters. It will not work with the Caster Spacer.
 To install the Envelope Tray, you must remove Tray 1 and replace it with the Envelope Tray.

Product Specifications

Lexmark CX943adtse

| Printing | |
|---|--|
| Display | Lexmark e-Task 25 cm (10-inch) class colour touch screen |
| Print Speed | Up to: Black: 55 ppm ¹ (A4) / Colour: 55 ppm ¹ (A4) |
| Time to First Page | as fast as: Black: 4.9 seconds / Colour: 4.9 seconds |
| Print Resolution | Black: 1200 x 1200 dpi, 2400 IQ (2400 x 600 dpi) / Colour: 1200 x 1200 dpi, 2400 IQ (2400 x 600 dpi) |
| Memory | standard: 4096 MB / maximum: 4096 MB |
| Hard Disk | Intelligent Storage Drive included; Magnetic Hard Disk available |
| Recommended Monthly Page Volume | 7,000 - 50,000 Pages ² |
| Maximum Monthly Duty Cycle | Up to: 270,000 pages per month ³ |
| Copying | |
| Copy Speed | Up to: Black: 55 cpm ¹ (A4) / Colour: 55 cpm ¹ (A4) |
| Time to First Copy | as fast as: black: 6.8 seconds / colour: 6.4 seconds |
| Scanning | |
| Scanner Type / ADF Scan | Flatbed scanner with automatic document feeder / DADF (single pass Duplex) |
| A4/Ltr Duplex Scan Speed | Up to: Mono: 146/144 sides per minute / Colour: 146/144 sides per minute |
| A4/Ltr Simplex Scan Speed | Up to: Mono: 73.5/72 sides per minute / Colour: 73.5/72 sides per minute |
| ADF Paper Input Capacity | Up to: 130 pages 75 gsm bond |
| Faxing | |
| Modem Speed | ITU T.30, V.34 Half-Duplex, 33.6 Kbps |
| Supplies ⁴ | |
| Laser Cartridge Yields | up to: 22,000 ⁵ -page Colour (CMY) Cartridges / up to: 45,000 ⁵ -page Black Cartridge |
| Cartridge(s) Shipping with Product | 18,500 ⁵ -page Black Toner Cartridge ⁵ , 11,500 ⁵ -page Colour (CMY) Toner Cartridges ⁵ |
| Paper Handling | |
| Included Paper Handling | 100-Sheet Multipurpose Feeder, 2 x 520-Sheet Tray, 400-Sheet Output Bin, 2 x 520-Sheet Tray/Caster |
| Optional Paper Handling | Booklet staple hole punch finisher, Inline Stapler, Dual Catch Bin, Envelope Tray, Caster spacer, Tri-fold/Z-fold booklet finisher, Staple Punch Finisher, Work table, 2000-Sheet Tray, 2000-Sheet Tandem Tray/Caster |
| Paper Input Capacity | Up to: Standard: 2,180 pages 75 gsm bond / Maximum: 4,180 pages 75 gsm bond |
| Paper Output Capacity | Up to: Standard: 400 pages 75 gsm bond / Maximum: 3,600 pages 75 gsm bond |
| Media Types Supported | Labels, Card Stock, Plain Paper, Envelopes, Glossy paper, Refer to the Paper & Speciality Media Guide |
| Media Sizes Supported | A6, Oficio, 7 3/4 Envelope, JIS-B4, 9 Envelope, B5, JIS-B5, A3, Ledger, A4, Legal, SRA3, A5, Hagaki Card, Letter, B5 Envelope, C4 Envelope, Statement, C5 Envelope, Executive, DL Envelope, Folio, 10 Envelope |
| General Information | |
| Standard Ports | Gigabit Ethernet (10/100/1000), Front USB 2.0 Specification Hi-Speed Certified port (Type A), Rear USB 2.0 Specification Hi-Speed Certified port (Type A), USB 2.0 Specification Hi-Speed Certified (Type B), One Internal Card Slot |
| Optional Network Ports / Optional Local Ports | MarkNet N8230 Fibre Ethernet Print Server, Marknet N8372 WiFi Option / Internal RS-232C serial |
| Noise Level | Operating: 49 dBA (Print) / 57 dBA (Copy) / 56 dBA (Scan) |
| Specified Operating Environment | Humidity: 8 to 80% Relative Humidity / Altitude: 0 - 2,500 Metres (8,200 Feet) / Temperature: 10 to 32°C (50 to 90°F) |
| Product Guarantee | 1-Year Onsite Repair, Next Business Day |
| Size / Weight | H x W x D: 1141 x 620 x 754 mm / 115.5 kg |
| ENERGY STAR Typical Electricity Consumption | TEC: 0.85 kilowatt-hours per week |

All information is subject to change without notice. Lexmark is not liable for any errors or omissions.

¹ Print and copy speeds measured in accordance with ISO/IEC 24734 and ISO/IEC 24735 respectively (ESAT). For more information see: www.lexmark.com/ISOspeeds.

² "Recommended Monthly Page Volume" is a range of pages that helps customers evaluate Lexmark's product offerings based on the average number of pages customers plan to print on the device each month. Lexmark recommends that the number of pages per month be within the stated range for optimum device performance, based on factors including: supplies replacement intervals, paper loading intervals, speed, and typical customer usage. ³ "Maximum Monthly Duty Cycle" is defined as the maximum number of pages a device could deliver in a month using a multishift operation. This metric provides a comparison of robustness in relation to other Lexmark printers and MFPs. ⁴ Product functions only with replacement cartridges designed for use in a specific geographical region. See www.lexmark.com/regions for more details. ⁵ Average continuous black or continuous composite CMY declared cartridge yield up to this number of standard pages in accordance with ISO/IEC 19798.

This is a Class A device according to international electromagnetic emissions standards (i.e. FCC Rules, EN 55022/EN 55032, etc.). Class A products are intended for use in non-residential/non-domestic environments. Use of a Class A product in residential/domestic environments may cause interference to radio communications and require corrective measures.

© 2022 Lexmark. All rights reserved.

Lexmark and the Lexmark logo are trademarks of Lexmark International, Inc., registered in the United States and/or other countries.

Apple and AirPrint are trademarks of Apple Inc., registered in the U.S. and other countries and regions. MOPRIA®, the Mopria® Logo, and the Mopria Alliance™ word mark and logo are registered and/or unregistered trademarks and service marks of Mopria Alliance, Inc. in the United States and other countries. Unauthorised use is strictly prohibited. ENERGY STAR and the ENERGY STAR mark are registered trademarks owned by the U.S. Environmental Protection Agency. EPEAT is a trademark of the Green Electronics Council in the United States and other countries. PANTONE® is the property of Pantone LLC. All other trademarks are the property of their respective owners.

This product includes software developed by the OpenSSL Project for use in the Open SSL Toolkit (<http://www.openssl.org/>).